

DECO-FLASH ANATOMY (MF SERIES)

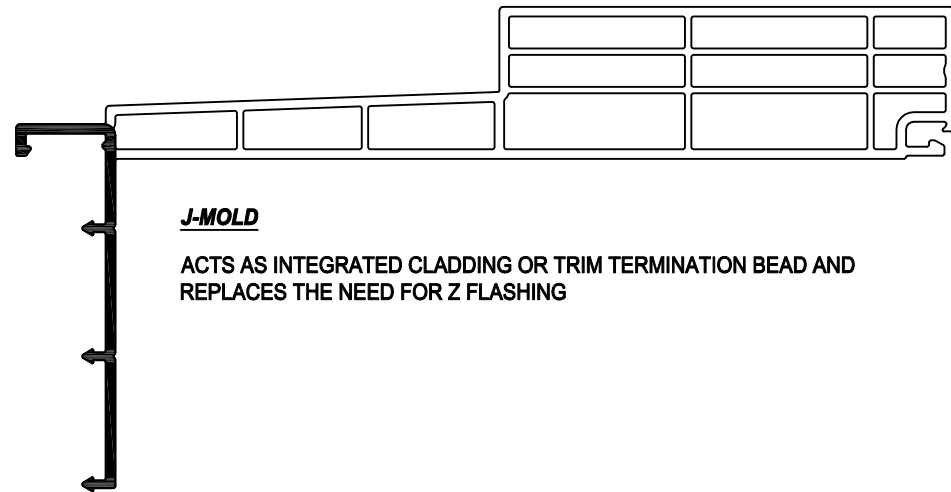

J-MOLD

ACTS AS INTEGRATED CLADDING OR TRIM TERMINATION BEAD AND REPLACES THE NEED FOR Z FLASHING

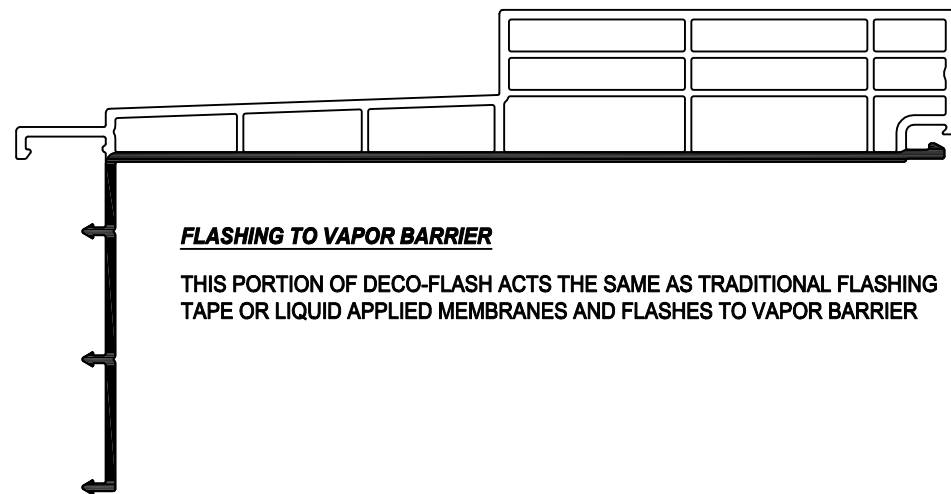

FLASHING TO VAPOR BARRIER

THIS PORTION OF DECO-FLASH ACTS THE SAME AS TRADITIONAL FLASHING TAPE OR LIQUID APPLIED MEMBRANES AND FLASHES TO VAPOR BARRIER

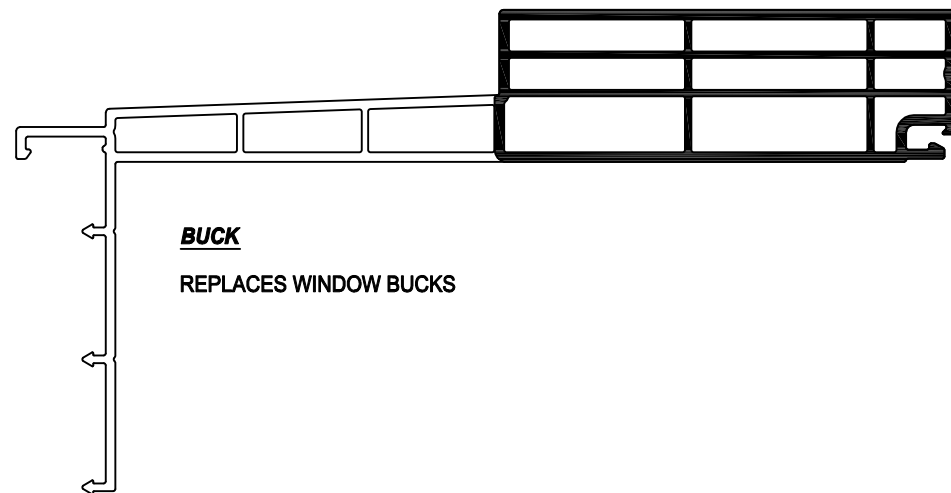

BUCK

REPLACES WINDOW BUCKS

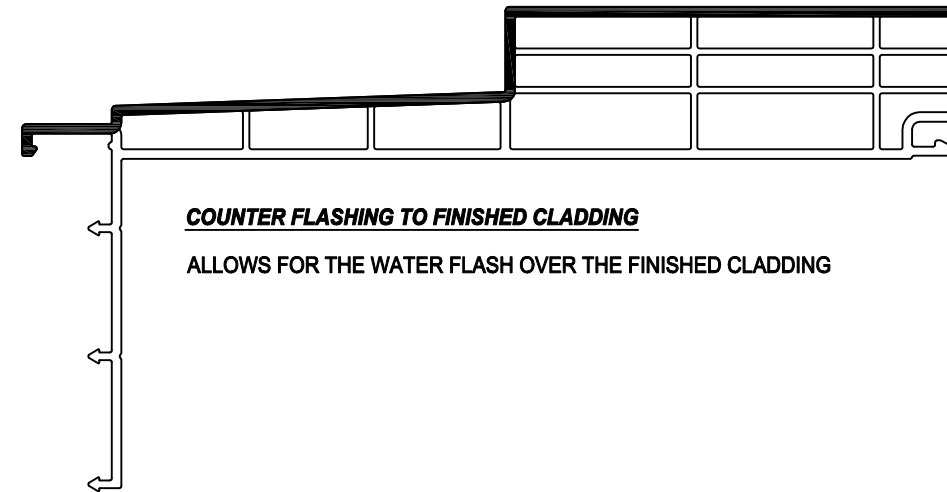

COUNTER FLASHING TO FINISHED CLADDING

ALLOWS FOR THE WATER FLASH OVER THE FINISHED CLADDING

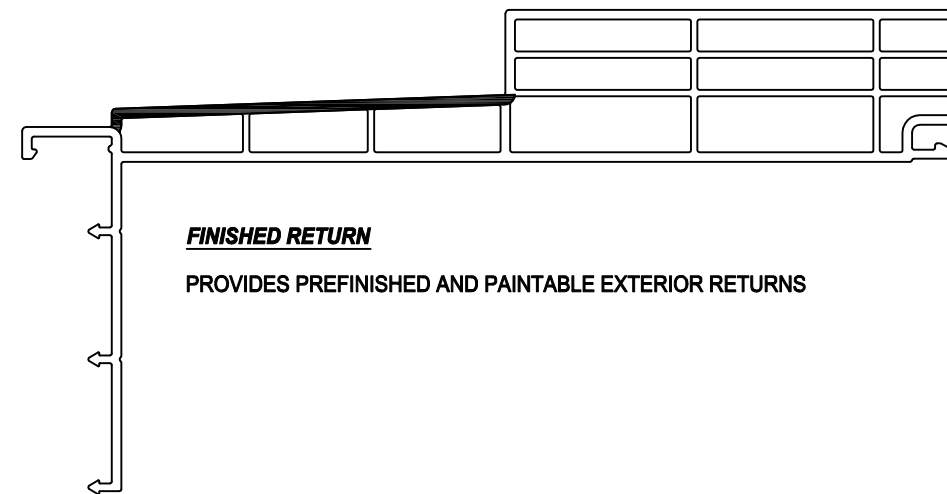

FINISHED RETURN

PROVIDES PREFINISHED AND PAINTABLE EXTERIOR RETURNS

DECO-FLASH[®]
4717 Oakfair Blvd.
Tampa, FL. 33610
Ph: 813-397-2827
www.deco-flash.com

This document and the information contained is owned by and proprietary to Deco-Flash. By receipt hereof, the holder agrees not to use the information, disclose it to any third parties nor reproduce this document without the prior written consent of Deco-Flash, and agrees to return this document forthwith upon request.

TOLERANCES X.XX ± 0.015 X.XXX ± 0.010 X.XXXX ± 0.005		CUSTOMER: DECO-FLASH			
<small>DO NOT SCALE DRAWING ALL DIMENSIONS ARE IN INCHES U.S.</small>		PART: DECO-FLASH ANATOMY (MF SERIES)			
SIZE: 17x11	COLOUR: VARIOUS	MATERIAL: RIGID PVC	AREA: - 2	TOOL NO.: -	DATE: 10-01-2016
SHEET: 1 of 1	DRAWN BY: -	SCALE: 1-1 1/2	VOLUME: -	PART NO.: -	DWG NO.: MF ANATOMY